

# 2

LONDON WALL PLACE

## LEVELS 2-9 SPACEPLAN CELLULAR LAYOUT

Net internal area 11,640 sq ft

Double fee earner offices x 24-28

Single fee earner offices 1

Total fee earners 49

Secretaries 1:14 fee earners 15

Legal support 1:14 fee earners 4

Business support 9

Total headcount 77

IPR per total fee earner 22 sq m/238 sq ft

IPR per total headcount 14 sq m/151 sq ft

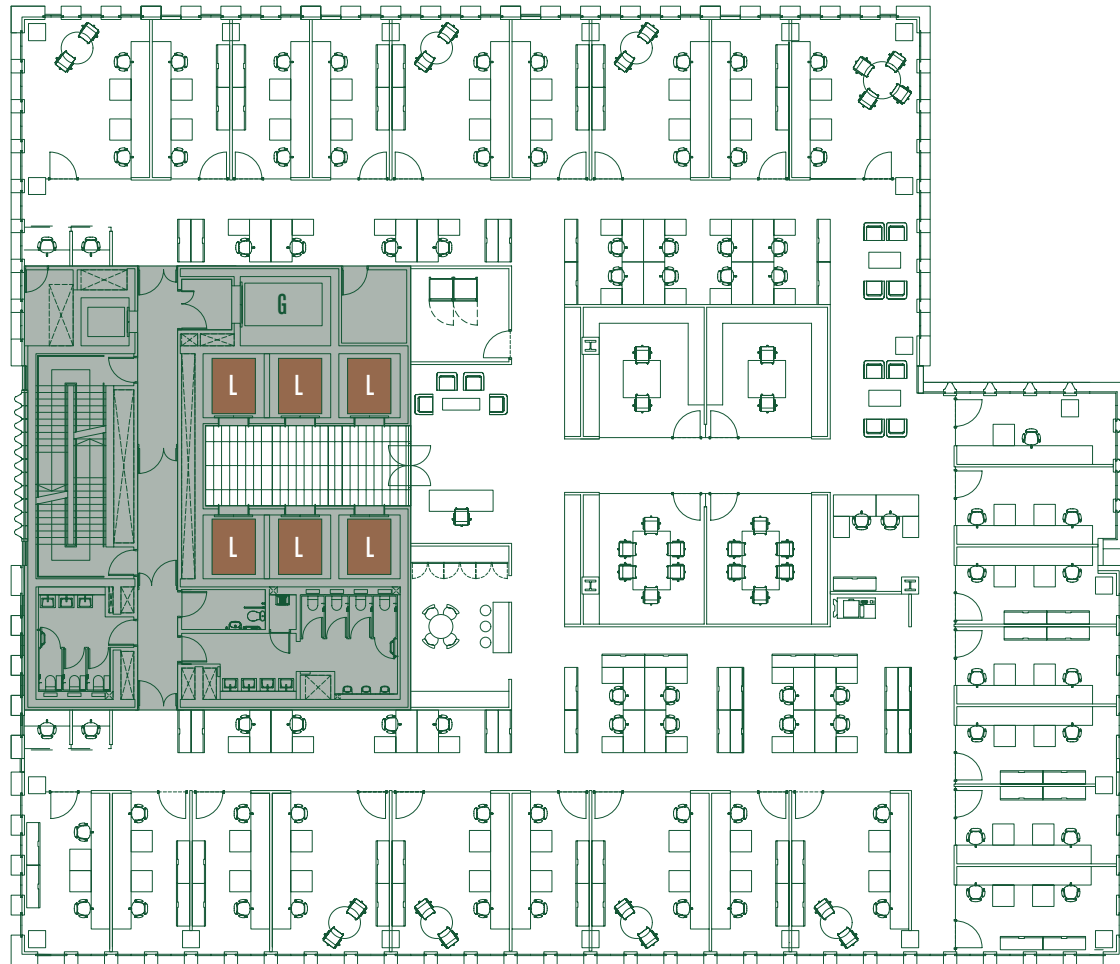

### KEY

Core Lifts Goods lift



# 2

LONDON WALL PLACE

## LEVELS 2-9 SPACEPLAN MIXED LAYOUT

Net internal area 11,640 sq ft

Cellular offices 9

Open plan workstations 100

Total headcount 109

IPR per total headcount 10 sq m/107 sq ft

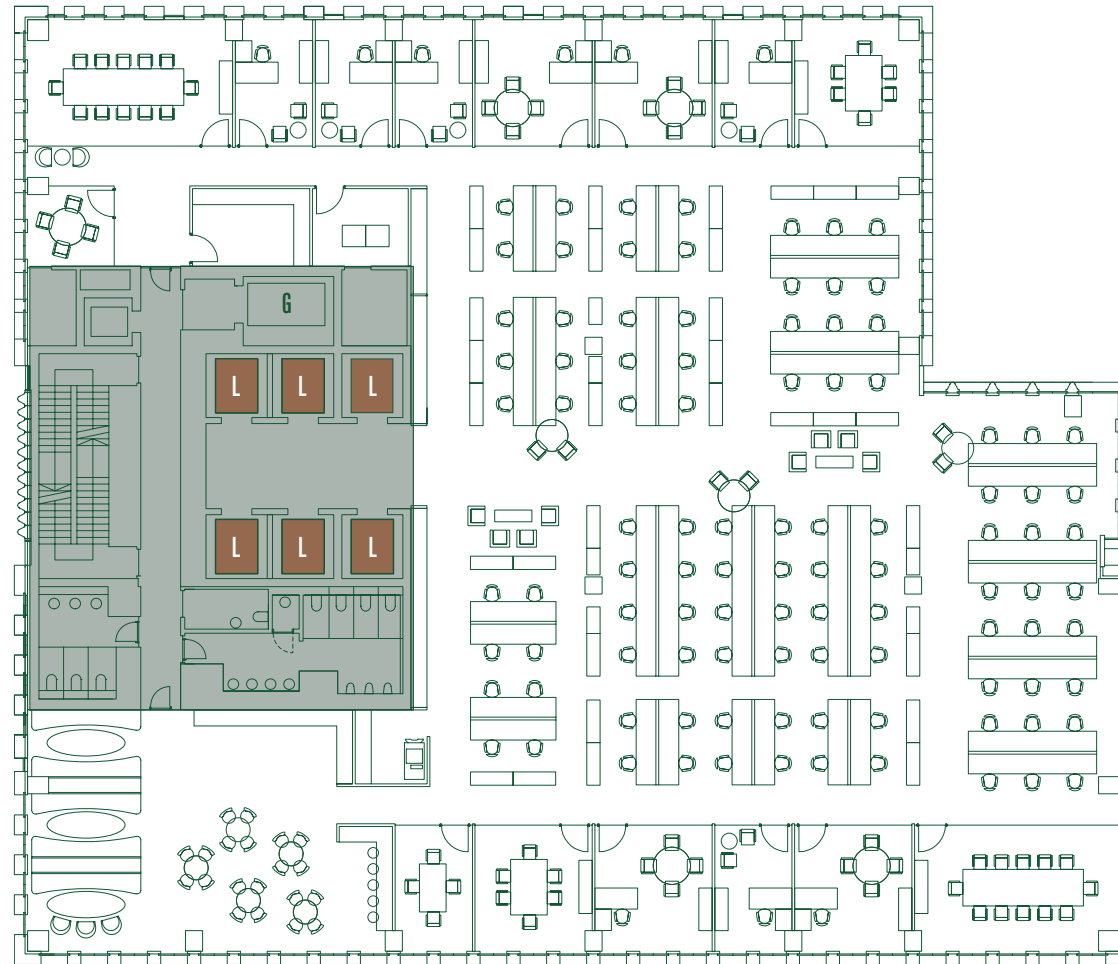

### KEY

Core Lifts Goods lift

